

# PROJECT SITE MAP

VW  
& P

## 1701-1713 N 42ND ST BY INSIGNIA DEVELOPMENT

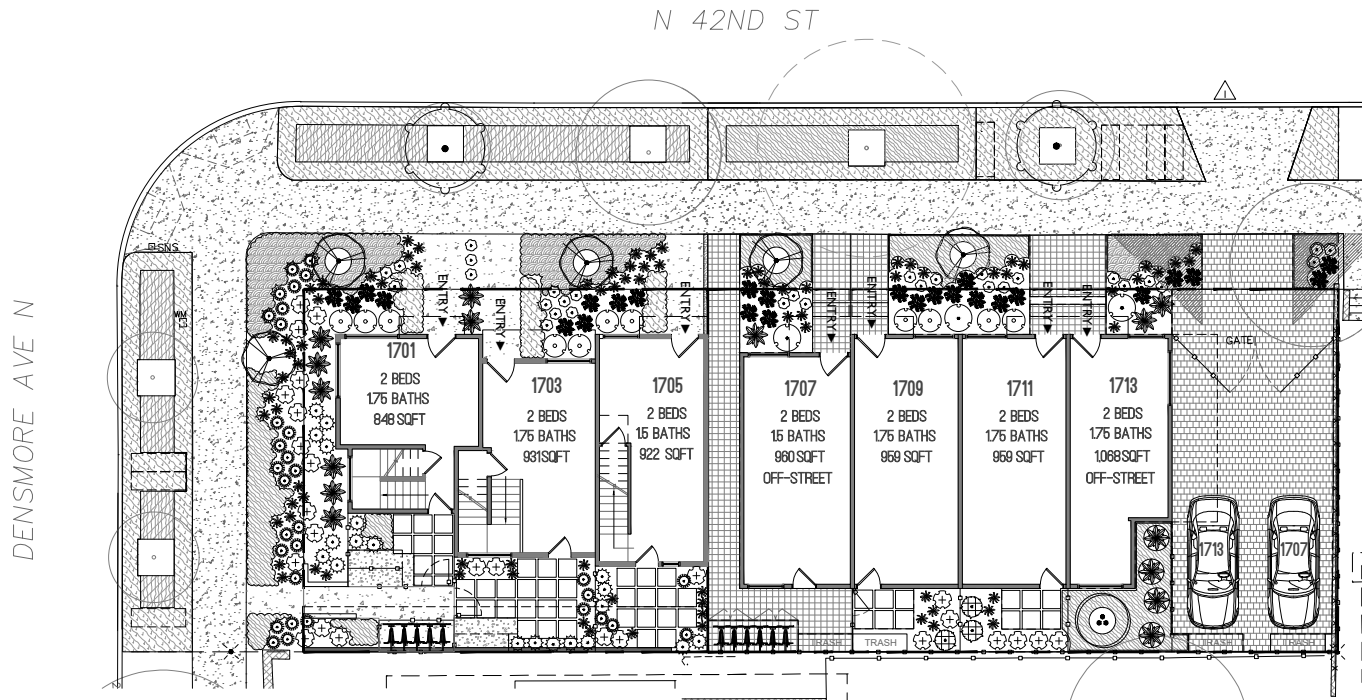

INFORMATION IS PROVIDED FOR GENERAL REFERENCE AND SHOULD NOT BE RELIED UPON.

VWP SALES:

206-673-3419

VWPSALES@WINDERMERE.COM

Windermere  
REAL ESTATE

VANWYCKANDPORTER.COM

